

MILE POST



ALIGNMENT- PLAN

DOT CROSSING NO
 CROSSING TCD/BRIDGE NO
 FL=FLASHING LIGHTS
 GATES=GATES XB=CROSS BUCK
 B=BELLS FM=FLAG MAN
 BR=RR BR OVER RR
 BR=RR BR OVER XING
 BRIDGE TYPES
 TRES=TIMBER TRESTLE
 PG=PLATE GIRDER BM=BEAM
 MOVE=MOVABLE RC=CONCRETE
 CULV=CULVERT TRUS=TRUSS
 DEFECTIVE EQUIP DET
 HOT BOX DET
 YARD LIMIT
 SIGNALS
 BRIDGE GR MAST T
 CANTILEVER BR L
 SEMAPHORE O DWARF T

PROFILE - PERCENT OF GRADE

ELEVATION

INTERLOCKING
 HAND OP = PS REMOTE=R:
 POWER SW = PS AUTO = A:
 ELECT LOCK = EL LOCAL=L:
 SPRING SW = SS

SIG CONTROL

SPEED

RAIL

BALLAST

PROGRAM-EIS #390
RAIL

BALLAST CLEAN

SURFACING

TIES

OTHER

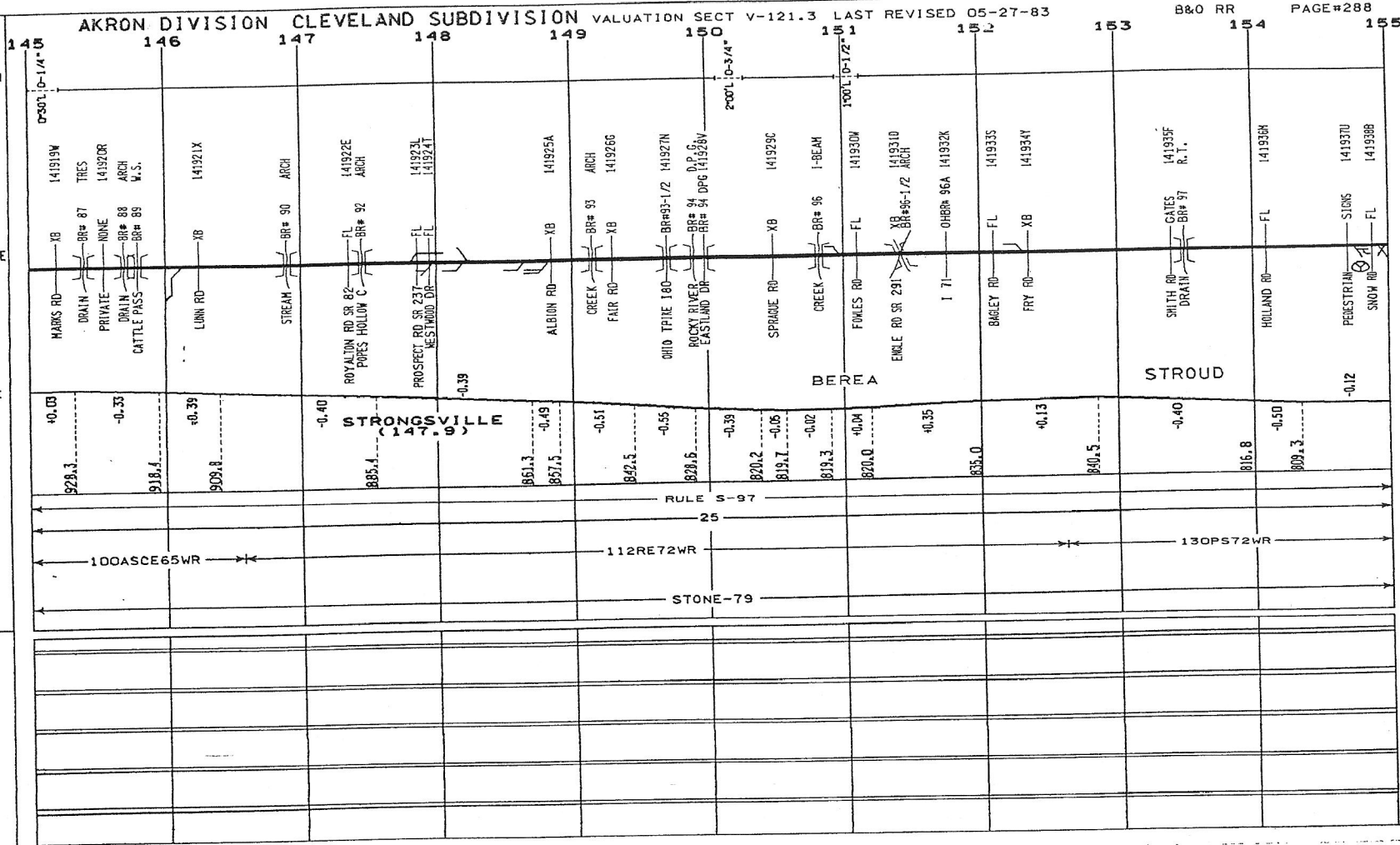



ALIGNMENT
PLAN
SUPERELEVATION
DEG OF CURVE

DOT CROSSING NO
CROSSING TCD / BRIDGE NO
FL=FLASHING LIGHTS
GATES=GATES XB=CROSS BUCK
B=BELLS FM=FLAG MAN
+ BR=XING BR OVER RR
+ BR=RR BR OVER XING
BRIDGE TYPES
TRES=TIMBER TRESTLE
PG=PLATE GIRDER BM-BEAM
HOVE=MOVABLE RC=CONCRETE
CULV=CULVERT TRUS=TRUSS
DEFECTIVE EQUIP DET
HOT BOX DET
YARD LIMIT
SIGNALS
BRIDGE BR MAST
CANTILEVER BR
SEMAPHORE DWARF

PROFILE - PERCENT OF GRADE

ELEVATION

INTERLOCKING
HAND OP = * REMOTE=R:
POWER SW = . PS AUTO = A:
ELECT LOCK = . EL LOCAL=L:
SPRING SW = . SS

SIG CONTROL

SPEED

RAIL

BALLAST

PROGRAM-EIS #390

RAIL

BALLAST CLEAN

SURFACING

TIES

OTHER

