

MILE POST



ALIGNMENT PLAN

SUPERELEVATION  
DEG OF CURVE

- DDT CROSSING NO
- CROSSING TCD / BRIDGE NO
- FL=FLASHING LIGHTS
- GATES=GATES XB=CROSS BUCK
- B=BELLS FH=FLAG MAN
- BR=XING BR OVER RR
- BR=RR BR OVER XING
- BRIDGE TYPES
- TRES-TIMBER TRESTLE
- PG=PLATE GIRDER BM=BEAM
- MOVE=MOVABLE RC=CONCRETE
- CULV=CULVERT TRUS=TRUSS
- DEFECTIVE EQUIP DET
- HOT BOX DET
- YARD LIMIT
- SIGNALS
- BRIDGE GR MAST
- CANTILEVER BR
- SEMAPHORE DWARF

PROFILE - PERCENT OF GRADE

ELEVATION

INTERLOCKING

- HAND OP = REMOTE=R
- POWER SW = PS AUTO=A2
- ELECT LOCK = EL LOCAL=L1
- SPRING SW = SS

SIG CONTROL

SPEED

RAIL

BALLAST

PROGRAM-EIS #863

RAIL

BALLAST CLEAN

SURFACING

TIES

OTHER

WESTERN DIVISION

MIAMI SUBDIVISION

VALUATION SECT V-41

LAST REVISED 01-25-83

C&D BY

PAGE 70

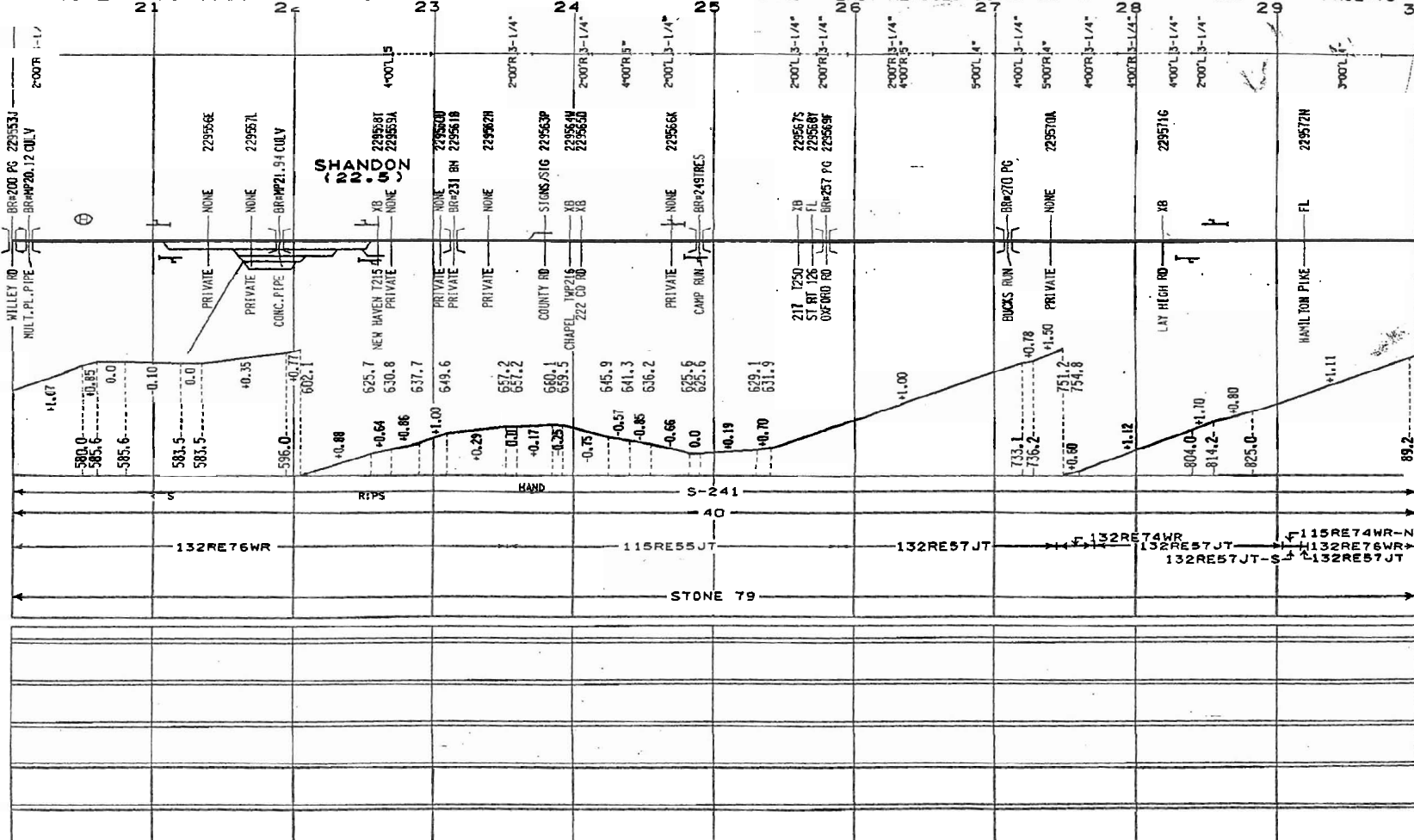

MILE POST



WESTERN DIVISION

MIAMI SUBDIVISION

VALUATION SECT V-51

LAST REVISED 01-25-83

C&O RY

PAGE=71

ALIGNMENT-PLAN

SUPERELEVATION  
DEG OF CURVE

DOT CROSSING NO

CROSSING TCD/BRIDGE NO

FL=FLASHING LIGHTS  
GATES=GATES XB=CROSS BUCK  
B=BELLS FH=FLAG HAN

BR=BR=XBING BR OVER RR  
BR=RR BR OVER XING

BRIDGE TYPES

TRES=TIMBER TRESTLE  
PG=PLATE GIRDER BM=BEAM  
MOVE=MOVABLE RC=CONCRETE  
CULV=CULVERT TRUS=TRUSS

DEFECTIVE EQUIP DET

HOT BOX DET

YARD LIMIT

SIGNALS

BRIDGE GR MAST

CANTILEVER BR

SEMAPHORE DWARF

PROFILE-PERCENT OF GRADE

ELEVATION

INTERLOCKING

HAND OP = PS REMOTE=R:  
POWER SW = PS AUTO =A:  
ELECT LOCK= EL LOCAL=L:  
SPRING SW = S

SIG CONTROL

SPEED

RAIL

BALLAST

PROGRAM-EIS #863

RAIL

BALLAST CLEAN

SURFACING

TIES

OTHER

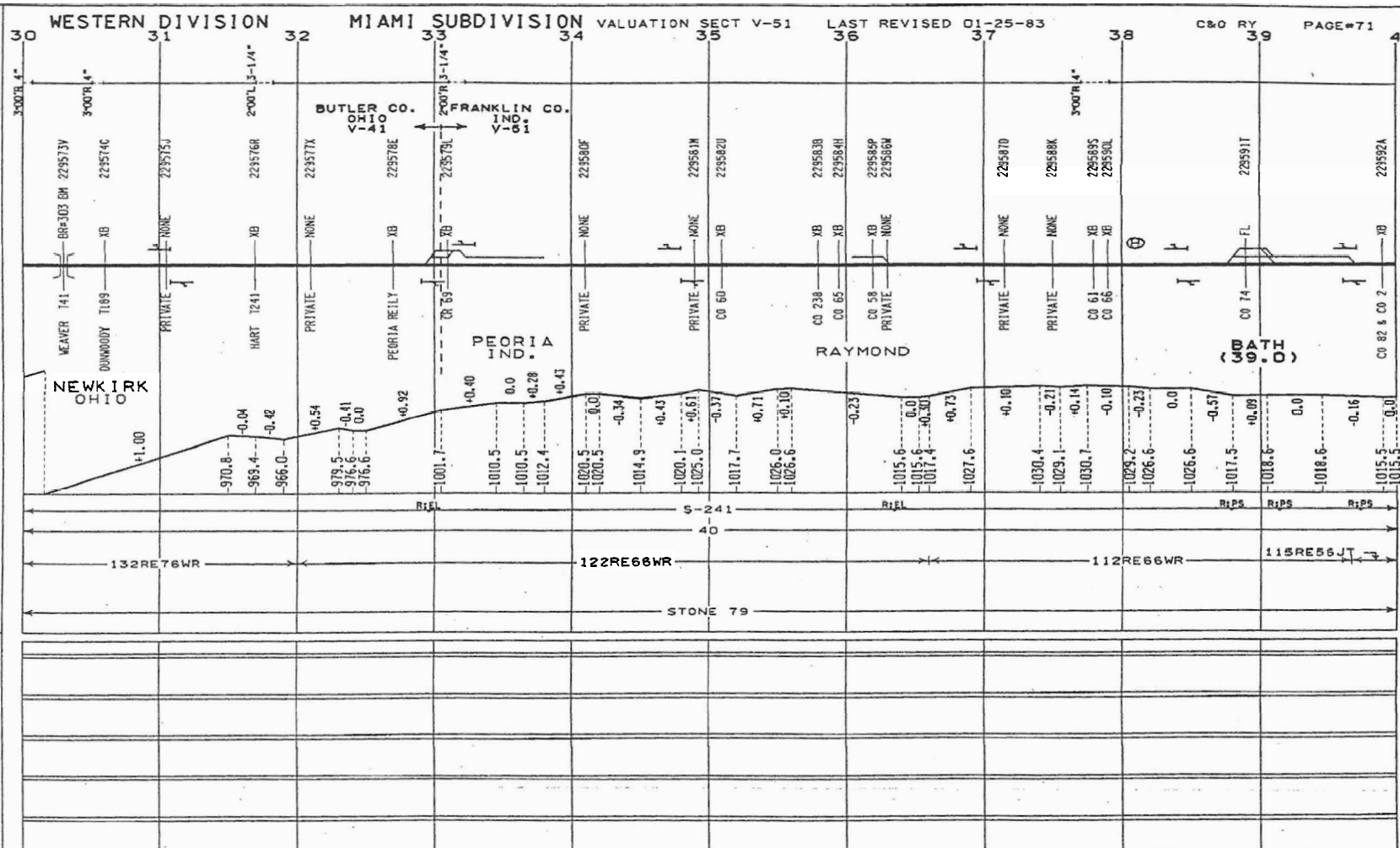

MILE POST E  
S  
N  
W

WESTERN DIVISION MIAMI SUBDIVISION VALUATION SECT V-51 LAST REVISED 01-25-83 C&O RY PAGE=72 50

ALIGNMENT PLAN  
SUPERELEVATION  
DEG OF CURVE

DOT CROSSING NO  
CROSSING TCD/BRIDGE  
FL=FLASHING LIGHTS  
GATES=GATES XB=CROSS BUCK  
B=BELLS  
FM=FLAG MAN  
BR==XING BR OVER RR  
BR==RR BR OVER XING  
BRIDGE TYPES  
TRES-TIMBER TRESTLE  
PG=PLATE GIRDER BM=BEAM  
MOVE=MOVABLE RC=CONCRETE  
CULV=CULVERT TRUS=TRUSS  
DEFECTIVE EQUIP DET  
HOT BOX DET  
YARD LIMIT  
SIGNALS  
BRIDGE GR MAST  
CANTILEVER BR  
SEMAPHORE DWARF

PROFILE—PERCENT OF GRADE

ELEVATION  
INTERLOCKING  
HAND OP REMOTE=R:  
POWER SW = PS AUTO=A:  
ELECT LOCK = EL LOCAL=L:  
SPRING SW = SS

SIG CONTROL  
SPEED

RAIL

BALLAST

PROGRAM-EIS #863  
RAIL

BALLAST CLEAN

SURFACING

TIES

OTHER

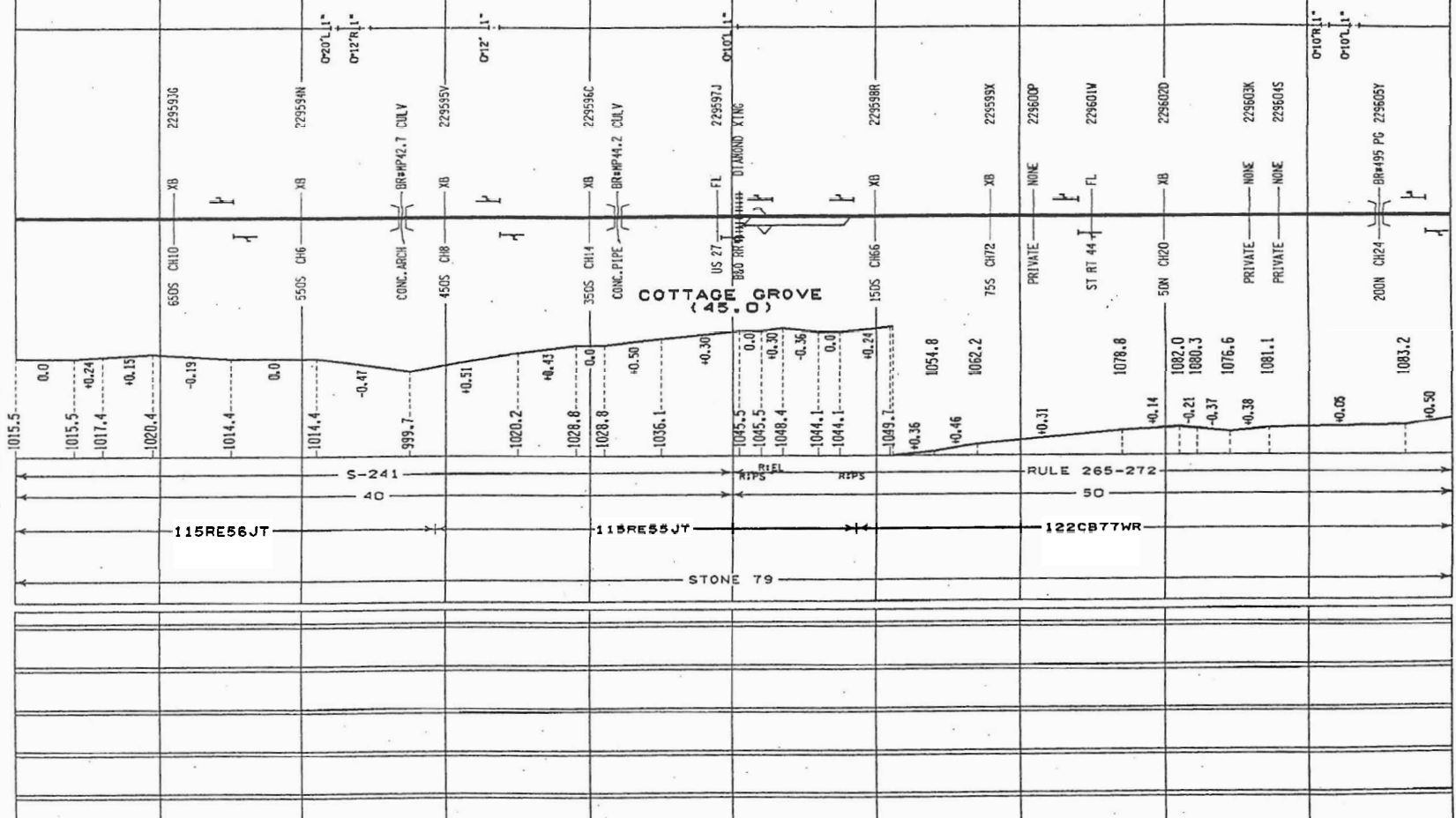

MILE POST

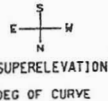

ALIGNMENT PLAN

DOT CROSSING NO  
 CROSSING TCD / BRIDGE NO  
 FL=FLASHING LIGHTS  
 GATES=GATES XB=CROSS BUCK  
 B=BELLS FM=FLAG MAN  
 BR=XING BR OVER RR  
 BR=RR BR OVER XING

BRIDGE TYPES  
 TR=TIMBER TRESTLE  
 PG=PLATE GIRDER BM=BEAM  
 HOV=MOVABLE RC=CONCRETE  
 CULV=CULVERT TRUS=TRUSS

DEFECTIVE EQUIP DET  
 HOT BOX DET  
 YARD LIMIT  
 SIGNALS

BRIDGE GR MAST  
 CANTILEVER BR  
 SEMAPHORE DWARF

PROFILE - PERCENT OF GRADE

ELEVATION

INTERLOCKING  
 HAND OP = REMOTE=R:  
 POWER SW = PS AUTO =A:  
 ELECT LOCK = EL LOCAL=L:  
 SPRING SW = SS

SIG CONTROL SPEED

RAIL

BALLAST

PROGRAM-EIS #863

RAIL

BALLAST CLEAN

SURFACING

TIES

OTHER

WESTERN DIVISION

MIAMI SUBDIVISION

VALUATION SECT V-51

LAST REVISED 01-25-83

C&O RY

PAGE #73

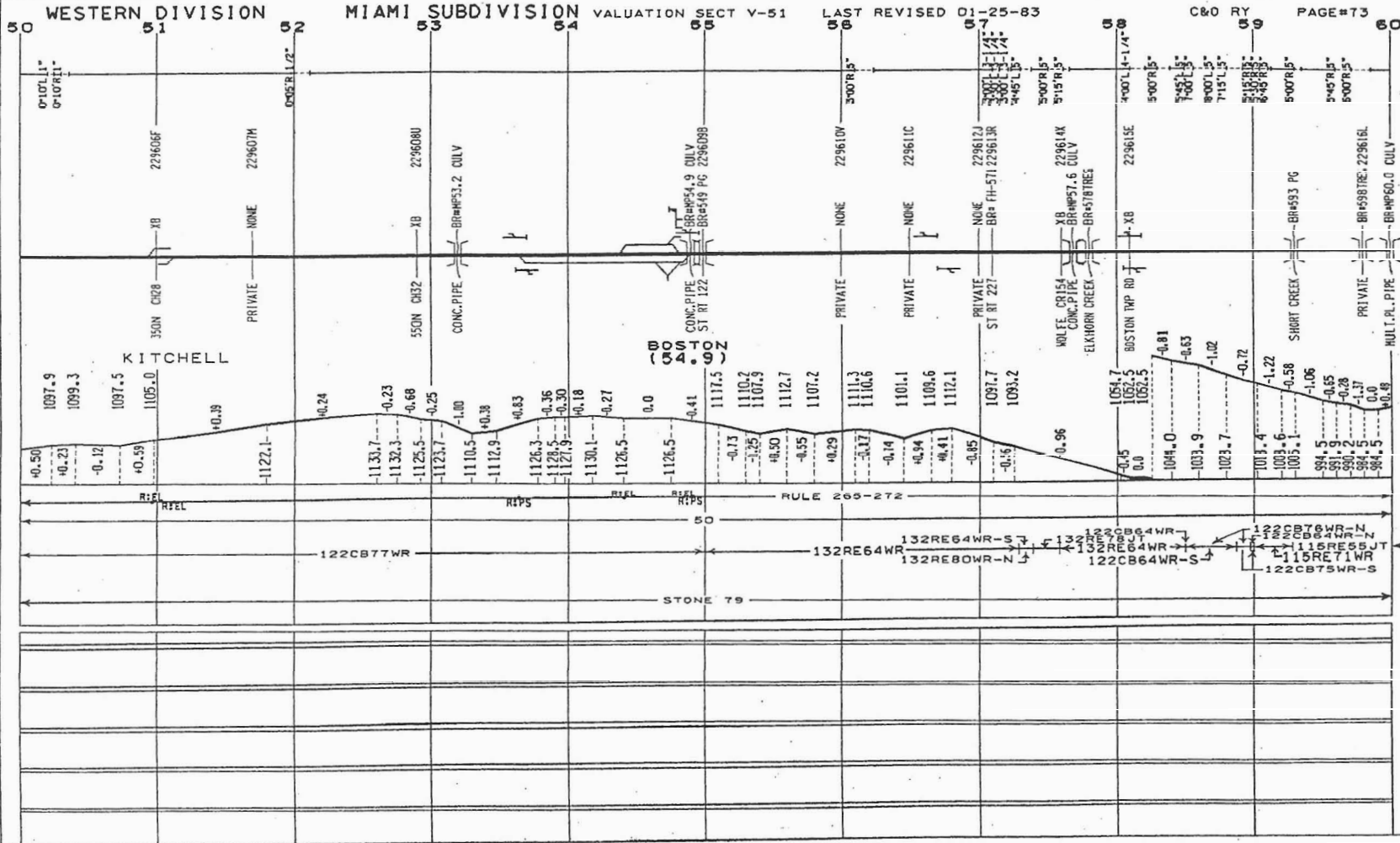



WESTERN DIVISION

MIAMI SUBDIVISION

VALUATION SHEET V-51

LAST REVISED 01-25-83

ALIGNMENT PLAN

- DOT CROSSING NO
- CROSSING TCD / BRIDGE NO
- FL=FLASHING LIGHTS
- GATES=GATES XB=CROSS BUCK
- B=BELLS FM=FLAC MAN
- BR=RR BR OVER RR
- BR=RR BR OVER RR
- BRIDGE TYPES
  - TRE=TIMBER TRESTLE
  - PG=PLATE GIRDER BM=BEAM
  - MOVE=MOVABLE RC=CONCRETE
  - CULV=CULVERT TRUS=TRUSS
- DEFECTIVE EQUIP DET
- HOT BOX DET
- YARD LIMIT
- SIGNALS
  - BRIDGE GR MAST
  - CANTILEVER BR
  - SEMAPHORE DWARF

PROFILE - PERCENT OF GRADE

ELEVATION

INTERLOCKING

- HAND OP = REMOTE=R
- POWER SW = PS AUTO=A
- ELECT LOCK = EL LOCAL=L
- SPRING SW = SS

SIG CONTROL

SPEED

RAIL

BALLAST

PROGRAM-EIS #863

RAIL

BALLAST CLEAN

SURFACING

TIES

OTHER

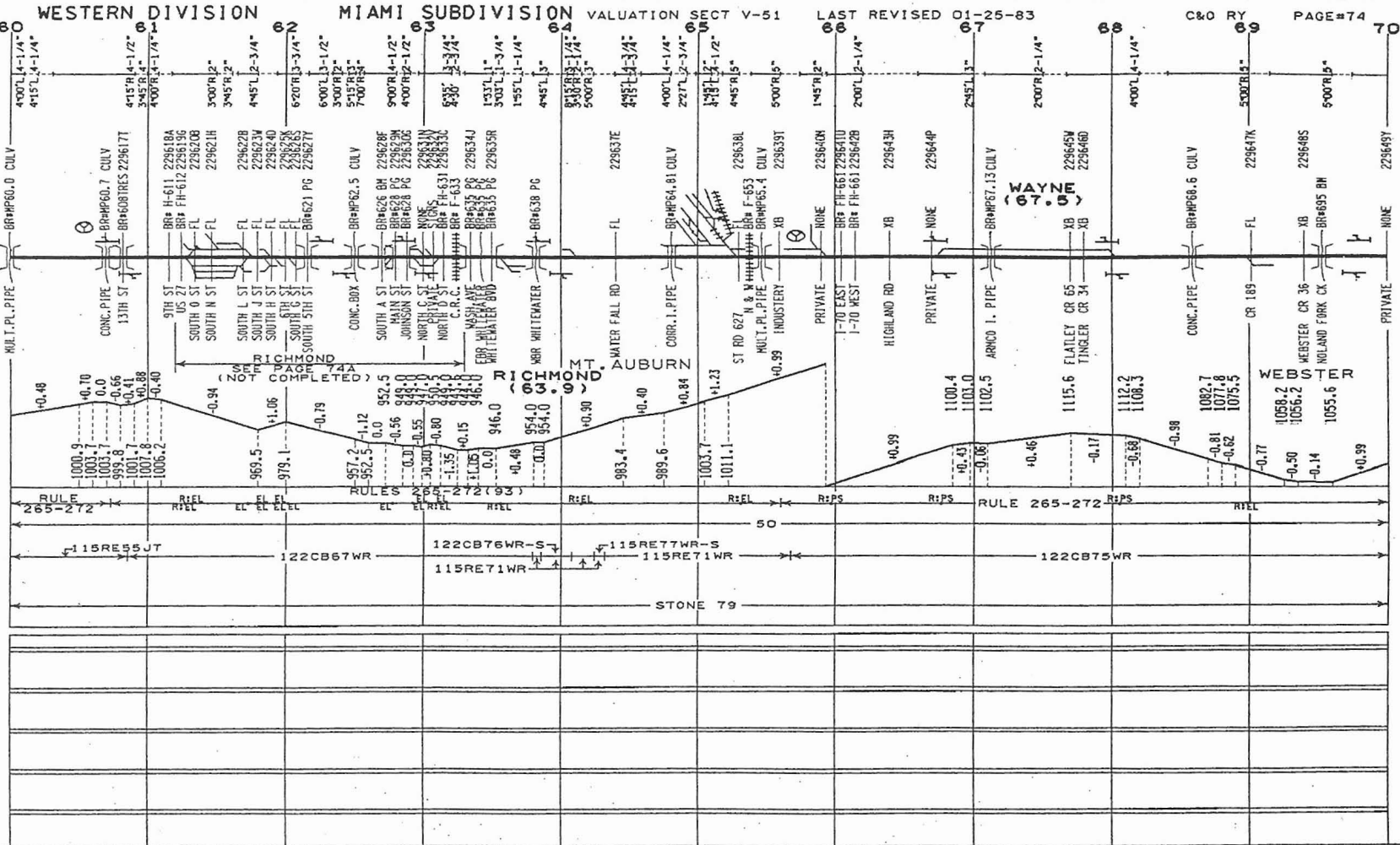

MILE POST

ALIGNMENT- SUPERELEVATION PLAN

DOT CROSSING NO  
 CROSSING TCD/BIDGE NO  
 FL=FLASHING LIGHTS  
 GATES=GATES XB=CROSS BUCK  
 B=BELLS  
 FM=FLAG MAN  
 \* BR=XING BR OVER RR  
 \* BR=RR BR OVER XING

BRIDGE TYPES  
 TRES=TIMBER TRESTLE  
 PG=PLATE GIRDER BM=BEAM  
 MOVE=MOVABLE RC=CONCRETE  
 CULV=CULVERT TRUS=TRUSS

DEFECTIVE EQUIP DET  
 HOT BOX DET  
 YARD LIMIT  
 SIGNALS  
 BRIDGE GR MAST  
 CANTILEVER BR  
 SEMAPHORE D WYAR

PROFILE-PERCENT OF GRADE

ELEVATION

INTERLOCKING  
 HAND OP = PS REMOTE=R  
 POWER SW = PS AUTO =A  
 ELECT LOCK = EL LOCAL=L  
 SPRING SW = SS

SIG CONTROL

SPEED

RAIL

BALLAST

PROGRAM-EIS #863

RAIL

BALLAST CLEAN

SURFACING

TIES

OTHER

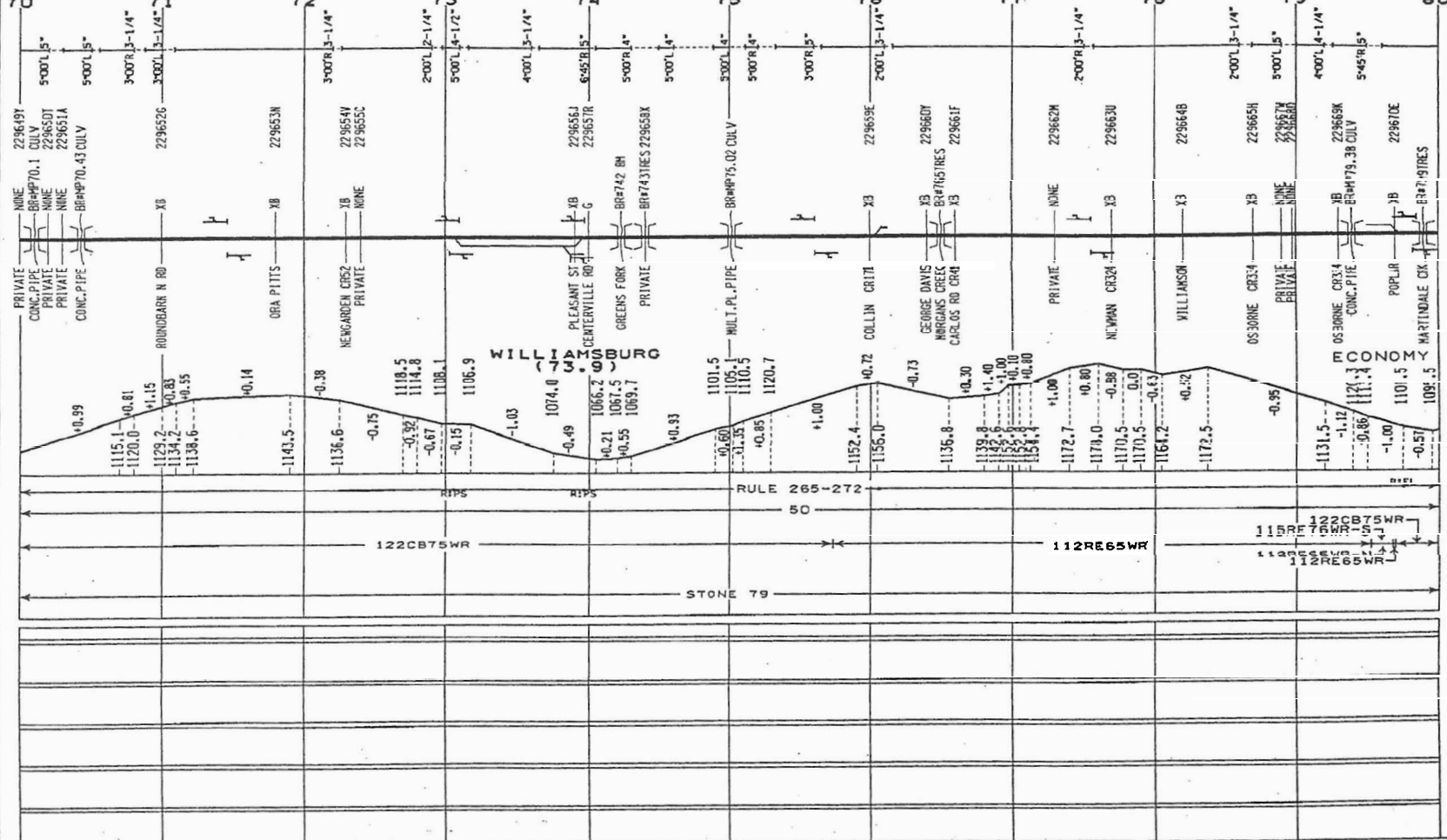

MILE POST



WESTERN DIVISION MIAMI SUBDIVISION VALUATION SECT V-51 LAST REVISED 01-25-83 C&O RY PAGE=76

ALIGNMENT- SUPERELEVATION  
PLAN DEG OF CURVE

DOT CROSSING NO  
CROSSING TCD/BRIDGE NO  
FL=FLASHING LIGHTS  
GATES=GATES XB=CROSS BUCK  
B=BELLS FM=FLAG MAN  
+ BR=XING BR OVER RR  
+ BR=RR BR OVER XING  
BRIDGE TYPES  
TRES=TIMBER TRESTLE  
PG=PLATE GIRDER BM=BEAM  
MOVE=MOVABLE RC=CONCRETE  
CULV=CULVERT TRUS=TRUSS  
DEFECTIVE EQUIP DET  
HOT BOX DET  
YARD LIMIT  
SIGNALS  
BRIDGE GR MAST  
CANTILEVER BR  
SEMAPHORE DWARF

PROFILE-PERCENT OF GRADE

ELEVATION  
INTERLOCKING  
HAND OP = REMOTE=R  
POWER SW = PS AUTO =A  
ELECT LOCK = EL LOCAL=L  
SPRING SW = SS

SIG CONTROL  
SPEED

RAIL

BALLAST

PROGRAM-EIS #863  
RAIL

BALLAST CLEAN

SURFACING

TIES

OTHER

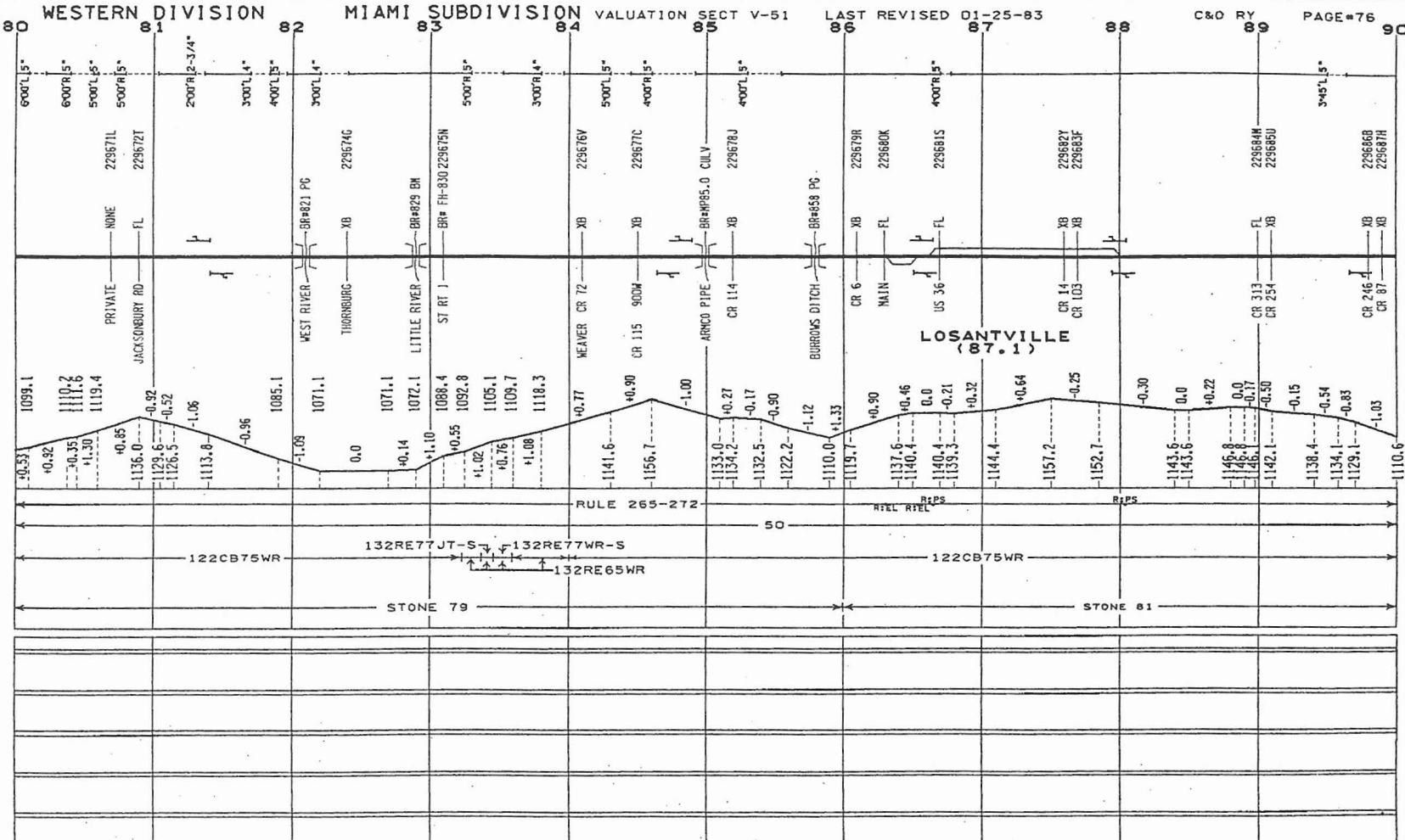

MILE POST



WESTERN DIVISION MIAMI SUBDIVISION VALUATION DISTRICT V-51 LAST REVISED 01-25-83 C&O RY PAGE #77 100

ALIGNMENT- SUPERELEVATION  
 PLAN DEG OF CURVE

DOT CROSSING NO  
 CROSSING TCD/BRIDGE NO  
 FL=FLASHING LIGHTS  
 GATES=GATES XB=CROSSB SBUCK  
 B=BELLS FM=FLAG MAN

BR=RR BR OVER RR  
 BR=RR BR OVER XING

BRIDGE TYPES  
 TRES=TIMBER TRESTLE  
 PG=PLATE GIRDER BH=BEAM  
 MOYE=MOVABLE RC=CONCRETE  
 CULV=CULVERT TRUS=TRUSS

DEFECTIVE EQUIP DET  
 HOT BOX DET  
 YARD LIMIT  
 SIGNALS  
 BRIDGE GR MAST  
 CANTILEVER BR  
 SEMAPHORE DWARF

PROFILE-PERCENT OF GRADE

ELEVATION

INTERLOCKING

HAND OP = R REMOTE=R:  
 POWER SW = PS AUTO=A:  
 ELECT LOCK = EL LOCAL=L:  
 SPRING SW = SS

SIG CONTROL  
SPEED

RAIL

BALLAST

PROGRAM-EIS #863

RAIL

BALLAST CLEAN

SURFACING

TIES

OTHER

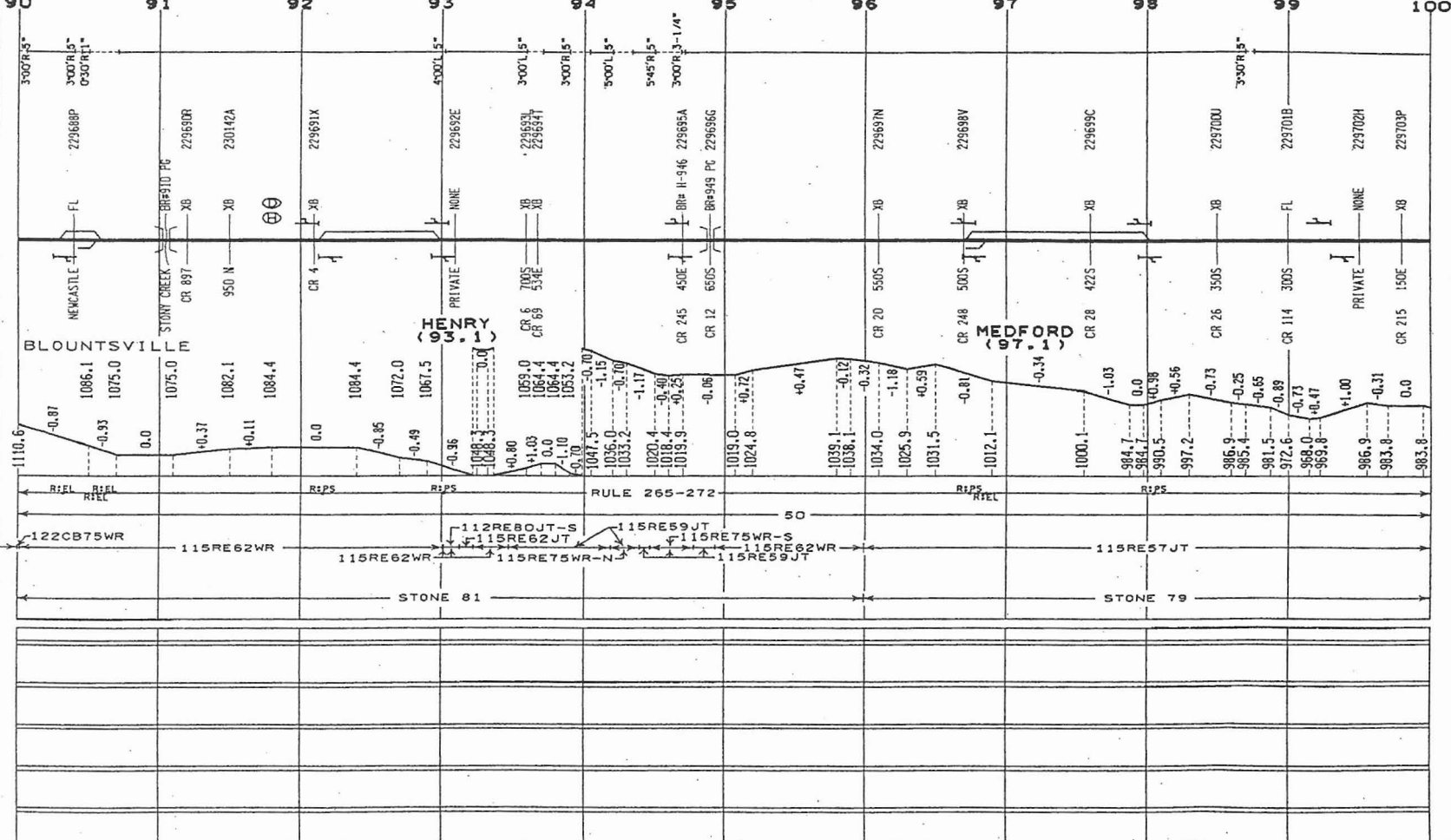



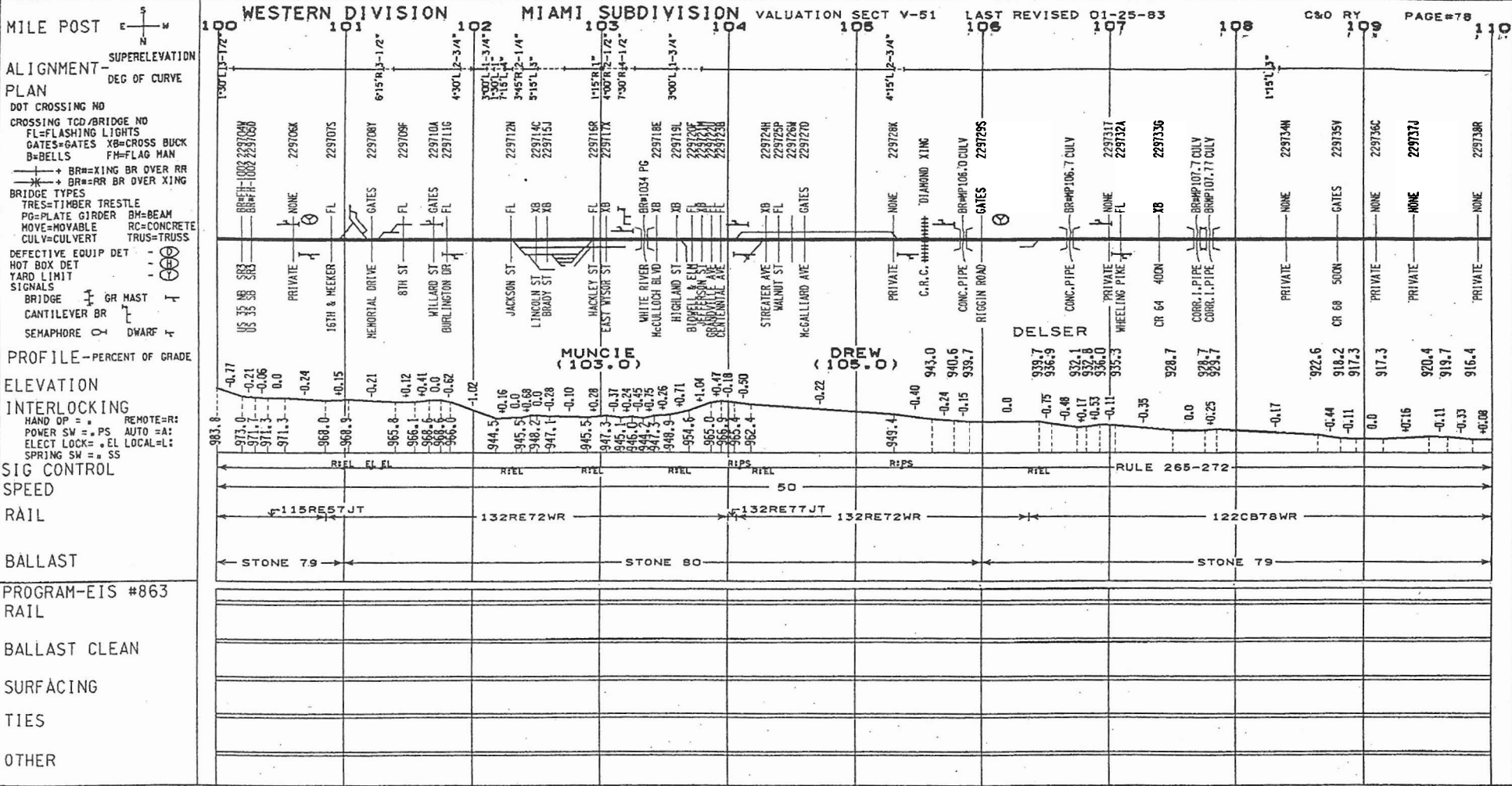

MILE POST

**ALIGNMENT-PLAN**  
 SUPERELEVATION  
 DEG OF CURVE  
 DOT CROSSING NO  
 CROSSING TCD/BRIDGE NO  
 FL=FLASHING LIGHTS  
 GATES=GATES XB=CROSS BUCK  
 B=BELLS FH=FLAG MAN  
 BR=XING BR OVER RR  
 BR=RR BR OVER XING  
**BRIDGE TYPES**  
 TRES=TIMBER TRESTLE  
 PG=PLATE GIRDER BH=BEAM  
 HOVE=MOVABLE RC=CONCRETE  
 CULV=CULVERT TRUS=TRUSS  
**DEFECTIVE EQUIP DET**  
 HOT BOX DET  
 YARD LIMIT  
**SIGNALS**  
 BRIDGE GR MAST  
 CANTILEVER BR  
 SEMAPHORE DWARF

**PROFILE-PERCENT OF GRADE**  
 ELEVATION  
 INTERLOCKING  
 HAND OP = REMOTE=R:  
 POWER SW = PS AUTO =A:  
 ELECT LOCK = EL LOCAL=L:  
 SPRING SW = SS

**SIG CONTROL**  
 SPEED  
 RAIL  
 BALLAST

PROGRAM-EIS #863  
 RAIL  
 BALLAST CLEAN  
 SURFACING  
 TIES  
 OTHER

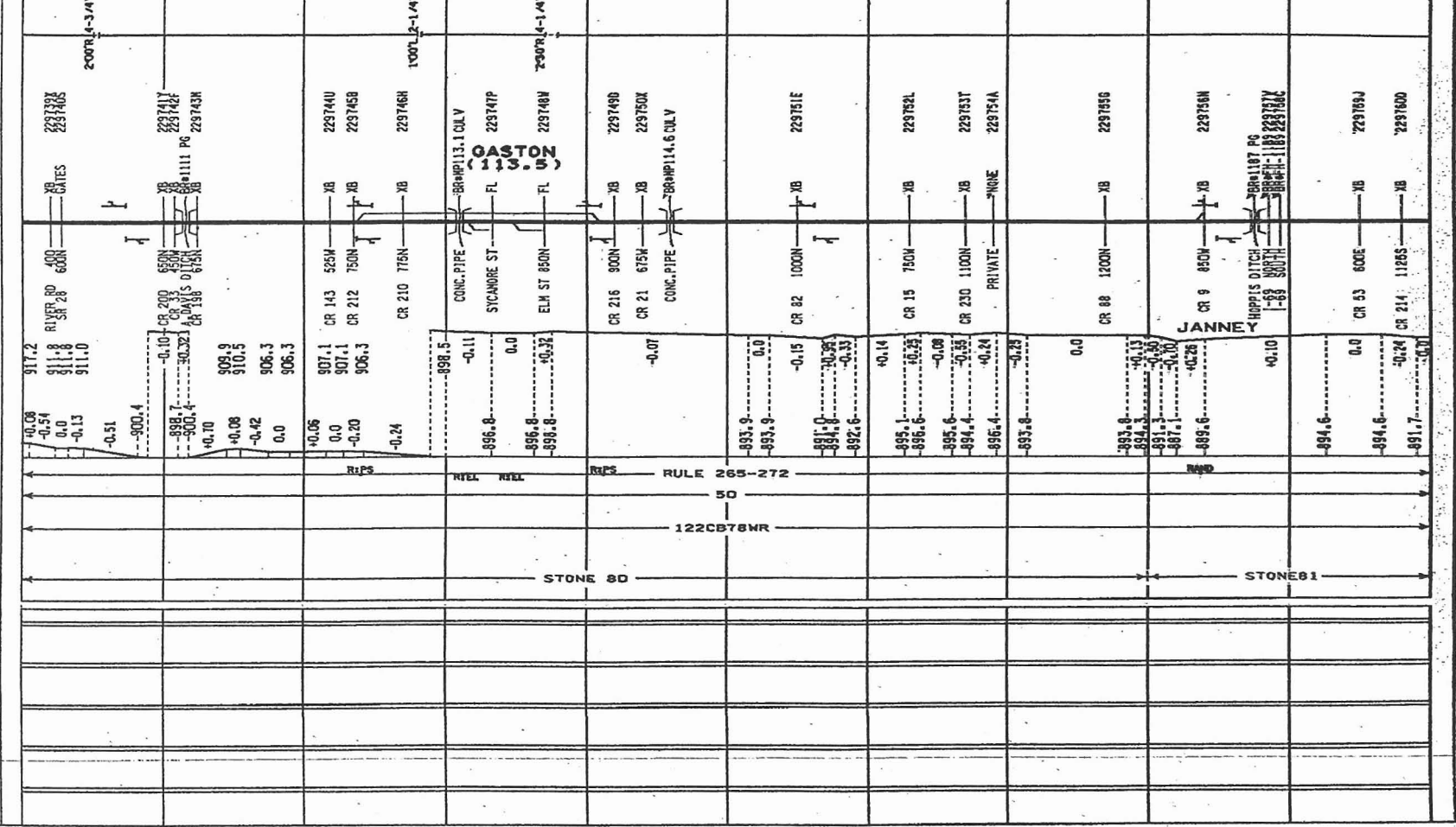

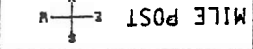

MILE POST SUPERELEVATION ALIGNMENT DEG OF CURVE PLAN

CROSSING TCD/RIDGE NO  
 FL=FLASHING LIGHTS  
 GATES=GATES XB=CROSS BUCK  
 B=BELLS  
 + BR=XING BR OVER RR  
 \* BR=RR BR OVER XING  
 BRIDGE TYPES  
 TR=TIMBER TRESITE  
 PG=PLATE GIRDER  
 MB=BARBEN  
 RC=CONCRETE  
 CUL=CULVERT  
 TRUS=TRUSS  
 DEFECTIVE EQUIP DET  
 YARD BOX DET  
 SIGMAIS  
 BRIDGE  
 CANTILEVER BR  
 SEMAPHORE  
 DWAFF

PROFILE - PERCENT OF GRADE  
 INTERLOCKING  
 REMOTE=RS  
 HAND OP =  
 POWER SW = PS  
 AUTO = AS  
 ELECT LOCK = EL  
 LOCAL-LS  
 SPRING SM = SS

SIG CONTROL  
 SPEED  
 RAIL  
 BALLAST

PROGRAM-EIS #863  
 BALLAST  
 RAIL

OTHER  
 TIES  
 SURFACING  
 BALLAST CLEAN

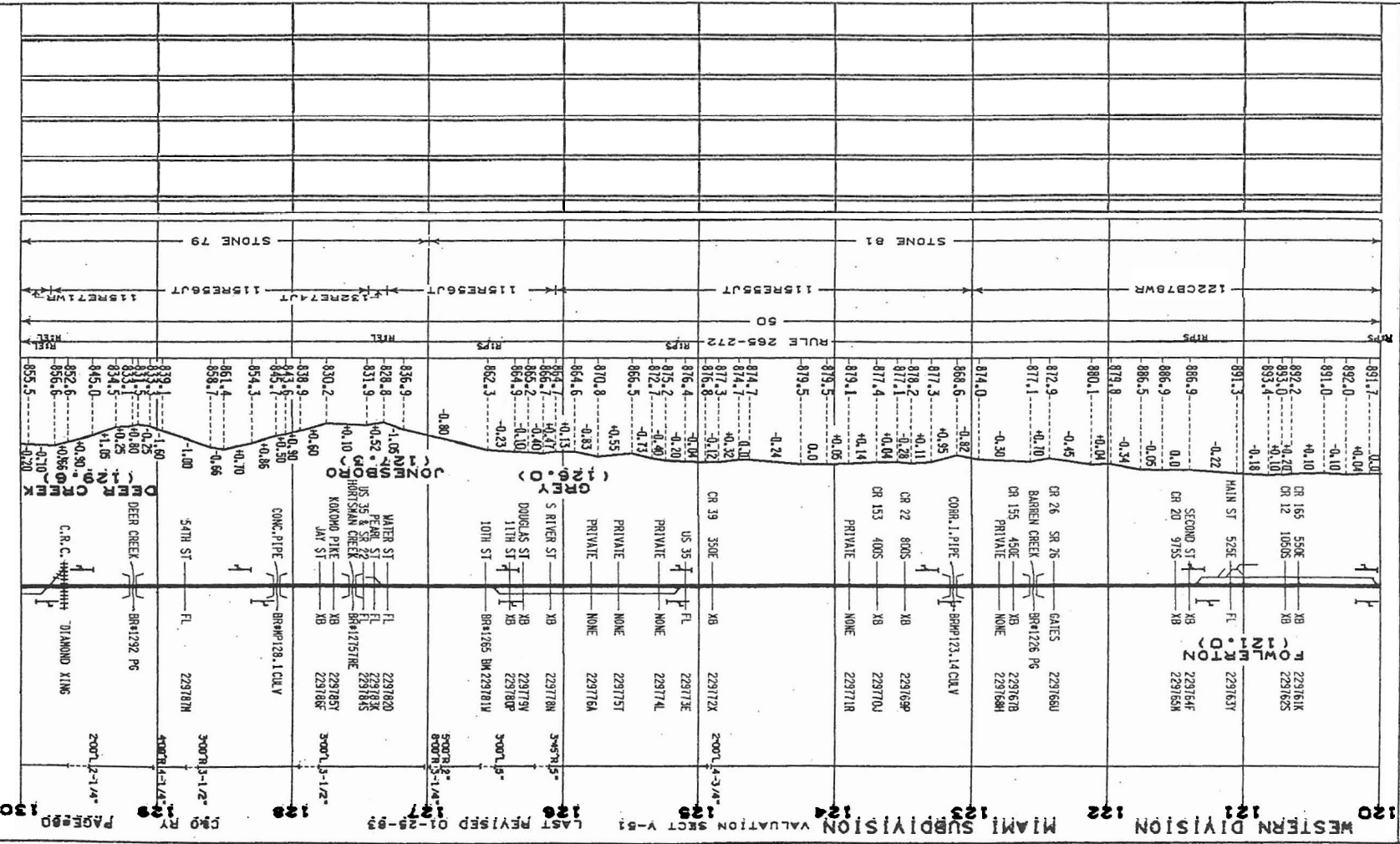

MILE POST  
 ALIGNMENT-PLAN  
 SUPERELEVATION  
 DEG OF CURVE  
 DOT CROSSING HD  
 CROSSING TCD/BRIDGE NO

FL=FLASHING LIGHTS  
 GATES=GATES XB=CROSS BUCK  
 B=BELLS FM=FLAG MAN  
 BR=XING BR OVER RR  
 BR=RR BR OVER XING  
 BRIDGE TYPES  
 TRESTLE  
 TRESTLE  
 PG=PLATE GIRDER BM=BEAM  
 MOVE=MOVABLE RC=CONCRETE  
 CULV=CULVERT TRUS=TRUSS

DEFECTIVE EQUIP DET  
 HOT BOX DET  
 YARD LIMIT  
 SIGNALS  
 BRIDGE  
 CANTILEVER BR  
 SEMAPHORE  
 GR MAST  
 DWARF

PROFILE-PERCENT OF GRADE  
 ELEVATION  
 INTERLOCKING  
 HAND OP = P PS  
 POWER SW = PS  
 ELECT LOCK = EL LOCAL=L1  
 REMOTE=R1  
 AUTO=A1  
 SPRING SW = SS

SIG CONTROL  
 SPEED  
 RAIL  
 BALLAST

PROGRAM-EIS #863  
 RAIL  
 BALLAST CLEAN  
 SURFACING  
 TIES  
 OTHER

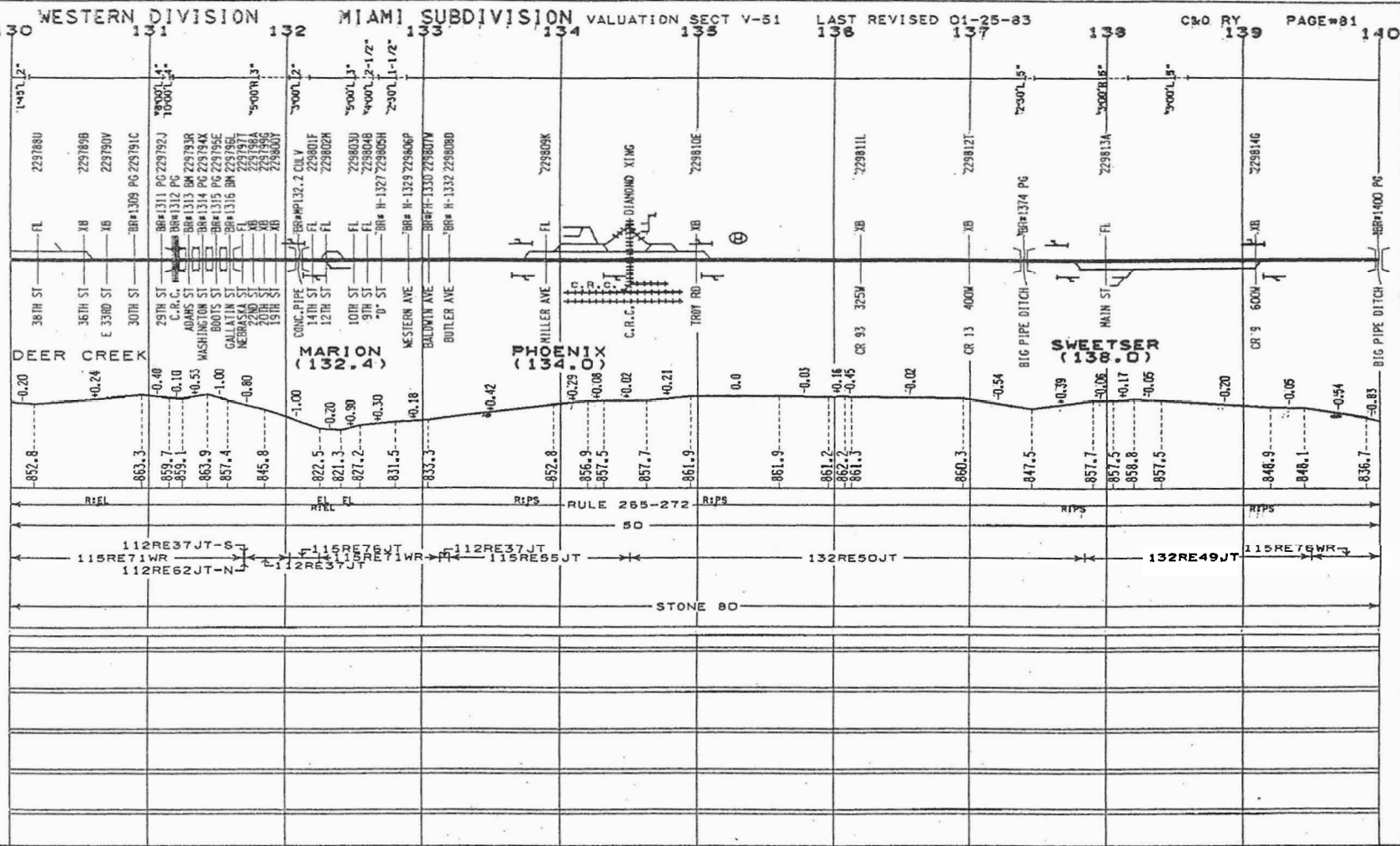



MILE POST

ALIGNMENT- PLAN

- SUPERELEVATION
- DEG OF CURVE
- DOT CROSSING NO
- CROSSING TCD/BRIDGE NO
- FL=FLASHING LIGHTS
- GATES=GATES XB=CROSS BUCK
- B=BELLS FM=FLAG MAN
- BR=XING BR OVER RR
- RR=RR BR OVER XING
- BRIDGE TYPES
- TRES=TIMBER TRESTLE
- PG=PLATE GIRDER BH=BEAM
- MOVE=MOVABLE RC=CONCRETE
- CULV=CULVERT TRUS=TRUSS
- DEFECTIVE EQUIP DET
- HOT BOX DET
- YARD LIMIT
- SIGNALS
- BRIDGE GR MAST
- CANTILEVER BR
- SEMAPHORE DWARF

PROFILE - PERCENT OF GRADE

ELEVATION

- INTERLOCKING
- HAND OP = P
- POWER SW = P S
- ELECT LOCK = EL
- SPRING SW = S S
- REMOTE=R
- AUTO = A
- LOCAL=L

SIG CONTROL

SPEED

RAIL

BALLAST

PROGRAM-EIS #863

RAIL

BALLAST CLEAN

SURFACING

TIES

OTHER

WESTERN DIVISION

MIAMI SUBDIVISION

VALUATION SECT V-51

LAST REVISED

10-1-80

DATE PLOTTED

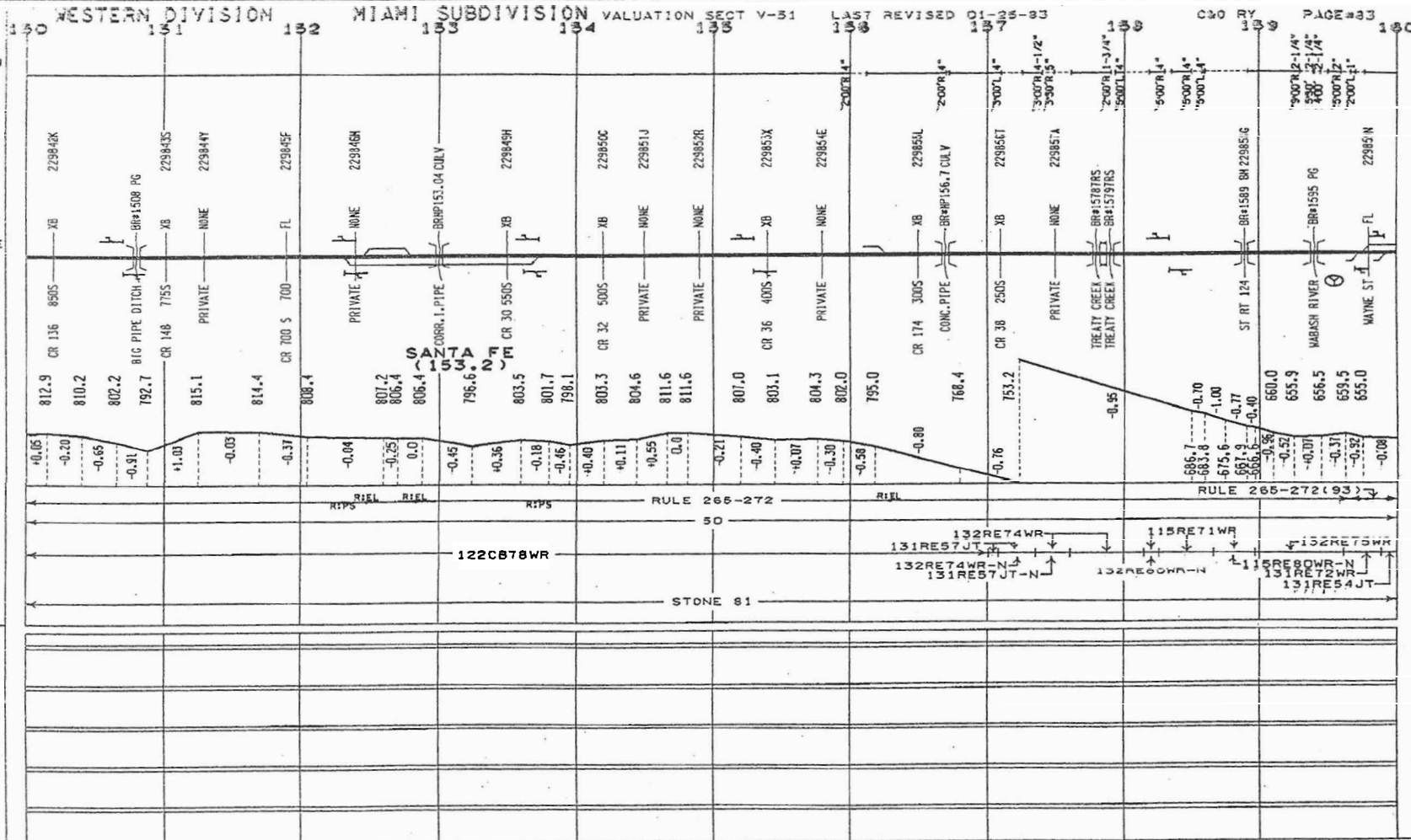

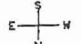
MILE POST 

ALIGNMENT- SUPERELEVATION  
 PLAN DEG OF CURVE

DDT CROSSING NO  
 CROSSING TCD/BRIDGE NO  
 FL=FLASHING LIGHTS  
 GATES=GATES XB=CROSS BUCK  
 B=BELLS FH=FLAG MAN

BR#XING BR OVER RR  
 BR#RR BR OVER XING

BRIDGE TYPES  
 TRES=TIMBER TRESTLE  
 PG=PLATE GIRDER BM=BEAM  
 MOVE=MOVABLE RC=CONCRETE  
 CULV=CULVERT TRUS=TRUSS

DEFECTIVE EQUIP DET - (C)  
 HOT BOX DET - (H)  
 YARD LIMIT - (Y)  
 SIGNALS

BRIDGE GR MAST  
 CANTILEVER BR  
 SEMAPHORE DWARF

PROFILE - PERCENT OF GRADE

ELEVATION

INTERLOCKING  
 HAND OP = \* REHOTE=R:  
 POWER SW = PS AUTO =A:  
 ELECT LOCK = EL LOCAL=L:  
 SPRING SW = S

SIG CONTROL

SPEED

RAIL

BALLAST

PROGRAM-EIS #863

RAIL

BALLAST CLEAN

SURFACING

TIES

OTHER

